

### Union

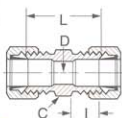
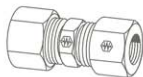

Assembly with long nut **1621x**

Tube O.D.	Catalog Number	Hex C	D	I	L
1/8	<b>621x2</b>	5/16	.094	.25	.66
3/16	<b>621x3</b>	3/8	.125	.28	.76
1/4	<b>621x4</b>	7/16	.188	.31	.79
5/16	<b>621x5</b>	1/2	.250	.34	.88
3/8	<b>621x6</b>	9/16	.312	.38	.97
1/2	<b>621x8</b>	11/16	.406	.44	1.10
5/8	<b>621x10</b>	13/16	.500	.50	1.25

### Male Connector

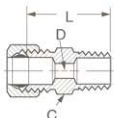

Assembly with long nut **1681x**

\* Available only as assembly with long nut.

Tube O.D.	Male Pipe Thread	Catalog Number	Hex C	D	L
1/8	1/16	<b>681x2x1</b>	3/8	.094	.78
1/8	1/8	<b>681x2</b>	7/16	.094	.78
3/16	1/8	<b>681x3</b>	7/16	.125	.84
1/4	1/8	<b>681x4</b>	7/16	.188	.88
1/4	1/4	<b>681x4x4</b>	9/16	.188	1.06
5/16	1/8	<b>681x5</b>	1/2	.234	.91
5/16	1/4	<b>681x5x4</b>	9/16	.250	1.09
3/8	1/8	<b>681x6x2</b>	9/16	.250	.97
3/8	1/4	<b>681x6</b>	9/16	.312	1.17
3/8	3/8	<b>681x6x6</b>	11/16	.312	1.16
3/8	1/2	<b>681x6x8</b>	7/8	.312	1.34
1/2	1/4	<b>681x8x4</b>	11/16	.281	1.22
1/2	3/8	<b>681x8</b>	11/16	.406	1.22
1/2	1/2	<b>681x8x8</b>	7/8	.406	1.41
5/8	1/2	<b>681x10</b>	7/8	.500	1.50
1	1	<b>1681x16*</b>	1-3/8	.875	2.00

### Female Connector

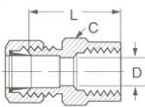
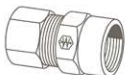

Assembly with long nut **1661x**

Tube O.D.	Fem. Pipe Thread	Catalog Number	Hex C	D	L
1/8	1/8	<b>661x2</b>	9/16	.094	.75
3/16	1/8	<b>661x3</b>	9/16	.125	.78
1/4	1/8	<b>661x4</b>	9/16	.188	.78
1/4	1/4	<b>661x4x4</b>	11/16	.188	1.03
5/16	1/8	<b>661x5</b>	9/16	.250	.81
3/8	1/8	<b>661x6x2</b>	9/16	.312	.84
3/8	1/4	<b>661x6</b>	11/16	.312	1.06
1/2	3/8	<b>661x8</b>	13/16	.406	1.12

### Male Ball Check Connector

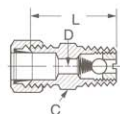

Assembly with long nut **1631x**. Min. pressure 3 psi. Ball and spring position may be reversed to change flow/check direction. Ballcheck valves are neither tested nor adjusted prior to sale.

Tube O.D.	Male Pipe Thread	Catalog Number	Hex C	D	L
1/4	1/8	<b>631x4</b>	7/16	.125	.88
3/8	1/4	<b>631x6</b>	9/16	.219	1.16



## SA-1 • SECONDARY AIR SYSTEMS KIT

Ideal for fleet repair shops, truck dealers, garages and truck stops. SA-1 contains an assortment of popular 1/8" and 1/4" brass fittings plus 200' of Weatherhead NT100 SAE J844 Nylon tubing. The 1/8" fittings are Weatherhead SELFALIGN® and 1/4" fittings are Weatherhead 1400 series air brake. The sturdy box keeps the tubing and fittings together for quick and easy servicing of the tubing used on shifters, PTO's, wipers, horns, remote air, instrumentation, etc. All of the parts are organized at your finger tips. The SA-1 is a must for all vehicle air system maintenance facilities.

**Size:** 15" wide, 3-1/2" high, 14-1/2" deep.

Catalog Number	Qty.	Catalog Number	Qty.
1460x4	10	601x2	10
1461x4	5	611x2	5
1462x4	2	621x2	2
1464x4	1	661x2	2
1468x4	2	681x2	2
1468x4x1	2	681x2x1	2
1468x4x4	2	691x2	2
1469x4	2	691x2x1	2
1469x4x4	2	BF-40X	1
1484x4	5	NT10002BK-100	100'
		NT10004BK-100	100'



## SA-2 • SECONDARY AIR SYSTEMS KIT

The SA-2 assortment enables you to supply fleets and dealers with fittings and tubing for 1/4" and 3/8" O.D. air brake applications. 1/8" O.D. tubing and fittings are also supplied for applications such as transmission shifter, air horn, gauge and flat adjustment. A cabinet is also supplied for easy storage on shelves and bench tops.

Catalog Number	Qty.	Catalog Number	Qty.
1460x4	10	1468x6x2	5
1460x6	20	1468x6x6	5
1461x4	5	1468x6x8	5
1461x6	10	1469x4	5
1462x4	5	1469x4x4	5
1462x6	10	1469x6	10
1464x4	2	1469x6x6	5
1464x6	2	601x2	10
1466x6	5	611x2	10
1468x4	5	621x2	5
1468x4x4	5	661x2	5
1468x4x6	2	681x2	5
1472x4	5	681x2x1	2
1472x6	5	691x2	5
1472x6x6x6	5	691x2x1	2
1484x4	10	BL-456-X	1
1484x6	10	FS-SA-2	1
1485x4	10	NT10002BK-100	100'
1485x6	10	NT10004BK-100	100'
1468x6	10	NT10006BK-100	100'