

 Refer to safety information on page 1 & 2.

## Vernier Controls

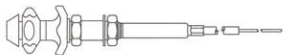

**Catalog Number: 8374**

New advanced styling. Meets or exceeds OEM specifications. Non-Corrosive aircraft aluminum body and stainless steel shaft assures 400 hour salt spray test without corrosion.

A direct replacement for most "Remote Throttle Controls": Mack Truck 21QB-180 Series, Kenworth K068B Series, Peterbilt 05-1462 Series, Volvo-White 13401 Series, I.H. 34084 Series, Muncie COCL Series BPC VCG Series. Also replaces most Garage and Service Station Wreckers remote control throttles; Earnest Holmes, Dover, etc.

## Turn-To-Lock Controls (T-Locking)



**Catalog Numbers: 8370, 8371**

New positive action control for small to mid-size engine throttles, governors, chokes, fuel shut-offs and more.

Aluminum body assures rust free performance. Patented Acetal Locking bushing guarantees never before possible settings with one third operator effort. Replaces Muncie COCL Series, and BPC R09 Series.

## Power Take Off Controls (Ball Knob)



**Catalog Numbers: 8372, 8373**

Utility grade as exact replacement for most P.T.O. Controls.

Features 2" Round Knobs, Galvanized Steel, vinyl covered casing and steel inner wire. All P.T.O. Controls meet or exceed OEM specifications. Replaces BPC R-38DS, R04, R38 and R38D Series, Muncie COKB Series.

Refer to safety information on page 1 & 2.

### Utility Light Load Controls (Dash)



Catalog Numbers: 8375, 8376, 8377, 8378

Universal light load Choke, Fuel-Shutoff, Throttle, Hood, Trunk and more! Controls are designed for most engine applications. Stainless steel inner-wire resists corrosion and assures trouble free operation. Vinyl coated.

### Throttle Stop



Catalog  
Number  
1548

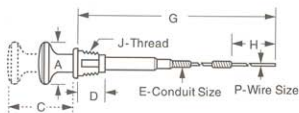

### SPECIFICATION CHART ON WEATHERHEAD "PUSH-PULL" CONTROLS

Description	Dash				T-Hood	T-Locking		PTO Control		Vernier	Deluxe PTO Control	
	8375	8376	8377	8378	8367	8370	8371	8372	8373	8374	106370	106470
Catalog Number	8375	8376	8377	8378	8367	8370	8371	8372	8373	8374	106370	106470
Length of "G"	84"	84"	84"	60"	180"	126"	186"	81"	165"	120"	192"	300"
Length of Wire "H"	9-3/8"	9-3/8"	9-3/8"	7"	5"	6"	6"	3"	3"	4-1/2"	12"	12"
Knob Type	Round				T-Handle	T-Handle		Round	Round	Round	Round	
Knob Size "A"	1.06"				2"	2"		2"	2"	2"	2"	
Knob Color	Black				Chrome	Chrome		Black	Black	Black	Red	
Knob Material	Plastic				Cast Zinc	Nylon		Plastic	Plastic	Plastic	Plastic	
Knob Lettering	Choke	Throttle	None	None	None	Lock		None	None	None	None	
Knob Travel "C"	2-1/2"				2-1/2"	3"		3-1/2"	3-3/8"	3-3/8"	4-1/2"	
Thread Size "J"	3/8"-24				3/8"-24	7/16"-20		7/16"-20	7/16"-20	3/4"-16	1/2"-20	
Thread Length "D"	1/2"				1/2"	3/4"		1-5/32"	2-1/2"	1-1/8"	1-1/8"	
Conduit Size "E"	3/16"				3/16"	3/16"		1/4"	1/4"	1/4"	3/8"	
Conduit Material & Style	Galvanized Steel				Steel Vinyl Cover	Galvanized Steel	Galvanized Steel	Galvanized Steel	Galvanized Steel	Galvanized Steel	High Carbon	
	Vinyl	Vinyl	Vinyl	Vinyl		Vinyl Covered	Vinyl Covered	Vinyl Covered	Vinyl Covered	Vinyl Covered	Polyethylene Lining & Cover	
Wire Size "P"	.054"				.054"	.054"		.088"	.088"	.0625"	.088"	