

Bushing

Stainless Steel No. 3121x
(Ref. SAE No. 140140)

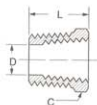

Male Pipe Thread	Female Pipe Thread	Catalog Number	Hex C	D	L
1/4	1/8	C3109x4x2*	5/8	.322	.85
3/8	1/8	C3109x6x2*	3/4	.332	.85
3/8	1/4	C3109x6x4*	3/4	.438	.85
1/2	1/8	C3109x8x2*	7/8	.332	1.10
1/2	1/4	C3109x8x4*	7/8	.438	1.10
1/2	3/8	C3109x8x6*	7/8	.562	1.10
3/4	1/4	C3109x12x4*	1-1/8	.438	1.17
3/4	3/8	C3109x12x6*	1-1/8	.562	1.17
3/4	1/2	C3109x12x8*	1-1/8	.703	1.17
1	3/8	C3109x16x6	1-3/8	.562	1.36
1	1/2	C3109x16x8*	1-3/8	.703	1.36
1	3/4	C3109x16x12*	1-3/8	.922	1.36
1-1/4	1/2	C3109x20x8	1-3/4	.703	1.47
1-1/4	3/4	C3109x20x12*	1-3/4	.922	1.47
1-1/4	1	C3109x20x16*	1-3/4	1.156	1.47
1-1/2	3/4	C3109x24x12	2	.906	1.58
1-1/2	1	C3109x24x16	2	1.141	1.58
1-1/2	1-1/4	C3109x24x20	2	1.500	1.57
2	1-1/4	C3109x32x20	2-1/2	1.484	1.75
2	1-1/2	C3109x32x24	2-1/2	1.719	1.75

Straight Thread O-Ring to Female Pipe Adapter

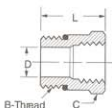

Male Port Size	Female Pipe Thread	Catalog Number	Straight Thread B	Hex C	D	L
1/4	1/8	C3269x4x2	7/16-20	9/16	.172	.97
1/4	1/4	C3269x4x4	7/16-20	3/4	.172	1.16
5/16	1/8	C3269x5x2	1/2-20	5/8	.234	.94
3/8	1/4	C3269x6x4	9/16-18	3/4	.297	1.09
3/8	3/8	C3269x6x6	9/16-18	7/8	.281	1.30
3/8	1/2	C3269x6x8	9/16-18	1-1/8	.281	1.44
1/2	1/4	C3269x8x4	3/4-16	7/8	.421	1.06
1/2	3/8	C3269x8x6	3/4-16	7/8	.421	1.22
1/2	1/2	C3269x8x8	3/4-16	1-1/16	.421	1.50
5/8	1/4	C3269x10x4	7/8-14	1	.422	.81
5/8	3/8	C3269x10x6	7/8-14	1	.500	1.25
5/8	1/2	C3269x10x8	7/8-14	1-1/8	.500	1.50
5/8	3/4	C3269x10x12	7/8-14	1-3/8	.500	1.62
3/4	1/2	C3269x12x8	1-1/16-12	1-1/4	.688	1.34
3/4	3/4	C3269x12x12	1-1/16-12	1-3/8	.656	1.66
7/8	3/4	C3269x14x12	1-3/16-12	1-3/8	.718	1.63
1	1/2	C3269x16x8	1-5/16-12	1-1/2	.688	1.00
1	3/4	C3269x16x12	1-5/16-12	1-1/2	.876	1.50
1	1	C3269x16x16	1-5/16-12	1-5/8	.876	1.88
1-1/4	1	C3269x20x16	1-5/8-12	1-7/8	1.080	1.00
1-1/4	1-1/4	C3269x20x20	1-5/8-12	2	1.080	1.94
1-1/2	1-1/2	C3269x24x24	1-7/8-12	2-3/8	1.312	1.88
2	2	C3269x32x32	2-1/2-12	2-7/8	1.781	1.91

Replacement o-rings page 147.

Adapter

Stainless Steel No. 3221x
(Ref. SAE 140139)

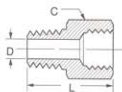

Female Pipe Thread	Male Pipe Thread	Catalog Number	Hex C	D	L
1/4	1/8	C3209x4x2*	3/4	.188	1.21
3/8	1/4	C3209x6x4*	7/8	.281	1.44
1/2	1/8	C3209x8x2*	1-1/8	.188	1.50
1/2	1/4	C3209x8x4*	1-1/8	.281	1.68
1/2	3/8	C3209x8x6*	1-1/8	.406	1.68
3/4	1/4	C3209x12x4*	1-3/8	.281	1.78
3/4	1/2	C3209x12x8*	1-3/8	.531	1.93
1	1/2	C3209x16x8*	1-5/8	.562	2.09
1	3/4	C3209x16x12*	1-5/8	.719	2.18
1-1/4	1	C3209x20x16	2	.938	2.46
1-1/2	1-1/4	C3209x24x20	2-3/8	1.25	2.50
2	1-1/2	C3209x32x24	2-7/8	1.500	2.63

*Available in stainless steel.

 Refer to safety information regarding tubing selection on page 1.

- **Typical Application:** Pressure hydraulic systems.
- **Sealing Method:** Performed by an elastomeric O-ring.
- **NOTE:** For pressure, material and plating information, refer to appropriate steel fitting sections of this catalog:

Pipe - See page 141. For-Seal - See page 149. JIC 37° - See page 159.

Ermeto - See page 190. Swivel Adapters - See page 214.

Straight Thread O-Ring Hex Socket Plug (Ref. SAE No. 090109B)



Replacement O-rings page 194.
NOTE: Parts furnished with zinc plate.

Port Size	Catalog Number	Hex C	L
1/8	7238x2	1/8	.40
3/16	7238x3	1/8	.40
1/4	7238x4	3/16	.47
5/16	7238x5	3/16	.47
3/8	7238x6	1/4	.50
1/2	7238x8	5/16	.58
5/8	7238x10	3/8	.65
3/4	7238x12	9/16	.77
7/8	7238x14	9/16	.77
1	7238x16	5/8	.77
1-1/4	7238x20	3/4	.78

Straight Thread O-Ring Hex Head Plug (Ref. SAE No. 090109A)

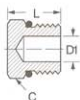

Replacement O-rings page 194.
NOTE: Parts furnished with zinc plate.

Port Size	Catalog Number	Hex C	L	D1 Opt.
1/8	7237x2	7/16	.60	.093
3/16	7237x3	1/2	.60	.125
1/4	7237x4	9/16	.67	.203
5/16	7237x5	5/8	.67	.234
3/8	7237x6	11/16	.73	.297
1/2	7237x8	7/8	.80	.422
5/8	7237x10	1	.93	.500
3/4	7237x12	1-1/4	1.09	.656
7/8	7237x14	1-3/8	1.09	.718
1	7237x16	1-1/2	1.12	.875
1-1/4	7237x20	1-7/8	1.20	1.093
1-1/2	7237x24	2-1/8	1.27	1.344
2	7237x32	2-3/4	1.42	1.815

Male Straight Thread/Female Straight Thread O-Ring Boss

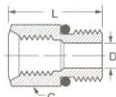

Replacement O-rings page 194.
NOTE: Parts furnished with zinc plate.

Male Port Size	Fem. Port Size	Catalog Number	Hex C	D	L
1/2	3/8	7033x8x6	7/8	.391	1.16
5/8	1/2	7033x10x8	1	.484	1.34
3/4	1/2	7033x12x8	1-1/4	.671	1.44
7/8	3/4	7033x14x12	1-3/8	.719	1.72
1	1/2	7033x16x8	1-1/2	.687	1.12
1	3/4	7033x16x12	1-1/2	.844	1.70
1-1/4	3/4	7033x20x12	1-7/8	.968	1.20
1-1/2	1-1/4	7033x24x20	2-1/8	1.312	1.75
2	1-1/2	7033x32x24	2-3/4	1.781	1.44

Straight Thread O-Ring Union

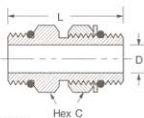

Replacement O-rings page 194.

Port Size	Catalog Number	Hex C	D	L
1/4	C5314x4x4	9/16	.172	1.37
3/8	C5314x6x6	11/16	.297	1.50
1/2	C5314x8x8	7/8	.391	1.56
5/8	C5314x10x10	1	.484	1.80
3/4	C5314x12x12	1-1/4	.609	2.33
1	C5314x16x16	1-1/2	.844	2.28
1-1/4	C5314x20x20	1-7/8	1.078	2.13
1-1/2	C5314x24x24	2-1/8	1.312	2.13
2	C5314x32x32	2-3/4	1.781	2.13