

Bulkhead Coupling (Brass)

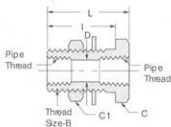

Fem. Pipe Thread	Catalog Thread	Thread Size B	Hex C	Hex C1	D	I	L
1/4	1344	3/4-16	1	15/16	.422	1.25	1.50
1/4	1345	3/4-16	1	15/16	.422	.69	.94
3/8	1346	1-14	1-1/8	1-3/8	.563	1.06	1.31
1/2	1351	1-1/8-14	1-1/4	1-3/8	.703	1.19	1.50

Bulkhead Coupling (Brass)

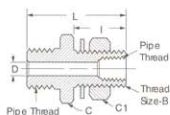

Male Pipe Thread	Fem. Pipe Thread	Catalog Number	Thread Size B	Hex C	Hex C1	D	I	L
1/2	1/4	1340	3/4-16	1-1/4	15/16	.312	1.13	2.16
1/2	1/4	1341	3/4-16	1-1/4	15/16	.312	1.53	2.53

Bulkhead Coupling (Brass)

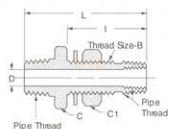

Male Pipe Thread	Fem. Pipe Thread	Catalog Number	Thread Size B	Hex C	Hex C1	D	I	L
1/2	1/4	1342	1-14	1-1/4	1-3/8	.375	1.88	2.94
1/2	1/4	1343	1-14	1-1/4	1-3/8	.375	2.88	3.94

Draincock

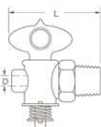

Male Pipe Thread	Catalog Number	D	L
1/4	W15310	.188	1.56

Shut Off Valve

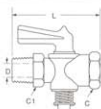

Rating: 125 psi with one 1/4" bubble in 5 seconds permissible key leakage.

Male Pipe Thread	Fem. Pipe Thread	Catalog Number	Hex C	Hex C1	D	L
1/4	1/4	W20332	5/8	3/4	.218	1.81

External Seat Draincock

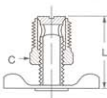

Male Pipe Thread	Catalog Number	Hex C	L
1/4	145	9/16	1.00

Bulkhead Coupling (Brass)

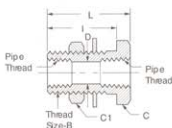

Fem. Pipe Thread	Catalog Thread	Thread Size B	Hex C	Hex C1	D	I	L
1/4	1344	3/4-16	1	15/16	.422	1.25	1.50
1/4	1345	3/4-16	1	15/16	.422	.69	.94
3/8	1346	1-14	1-1/8	1-3/8	.563	1.06	1.31
1/2	1351	1-1/8-14	1-1/4	1-3/8	.703	1.19	1.50

Bulkhead Coupling (Brass)

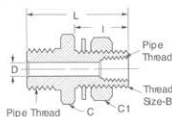

Male Pipe Thread	Fem. Pipe Thread	Catalog Number	Thread Size B	Hex C	Hex C1	D	I	L
1/2	1/4	1340	3/4-16	1-1/4	15/16	.312	1.13	2.16
1/2	1/4	1341	3/4-16	1-1/4	15/16	.312	1.53	2.53

Bulkhead Coupling (Brass)

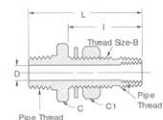

Male Pipe Thread	Fem. Pipe Thread	Catalog Number	Thread Size B	Hex C	Hex C1	D	I	L
1/2	1/4	1342	1-14	1-1/4	1-3/8	.375	1.88	2.94
1/2	1/4	1343	1-14	1-1/4	1-3/8	.375	2.88	3.94

45° Street Elbow (Ref. SAE No. 130339)

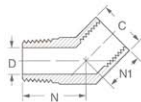

Male Pipe Thread	Fem. Pipe Thread	Catalog Number	C	D	N	N1
1/8	1/8	3350x2	9/16	.219	.50	.38
1/4	1/4	3350x4	11/16	.312	.74	.56
3/8	3/8	3350x6	13/16	.438	.78	.56
1/2	1/2	3350x8	1	.562	1.00	.76
3/4	3/4	3350x12	1-1/4	.750	1.06	.75

90° Street Elbow (Ref. SAE No. 130239)

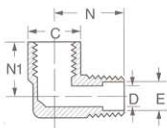

Fem. Pipe Thread	Male Pipe Thread	Catalog Number	C	D	E	N	N1
1/8	1/8	3400x2	9/16	.219	.25	.66	.47
1/8*	1/8**	3400x2W	1/2	.188	.25	.57	.34
1/4	1/8	3400x4x2	11/16	.219	—	.72	.53
1/4*	1/4**	3400x4W	11/16	.266	.36	.78	.45
1/4	1/4	3400x4	11/16	.312	—	.91	.72
3/8	3/8	3400x6	13/16	.438	—	.97	.78
1/2	1/2	3400x8	1	.562	—	1.25	1.03
3/4	3/4	3400x12	1-1/4	.750	—	1.38	1.12

- * PTF Short Thread
- ** PTF Special Short Thread