

Equipment

Coll-O-Crimp Portable T-480

 Refer to safety information regarding Coll-O-Crimp hose, hose fittings and assembly equipment compatibility on page 3.

T-480 • Portable Coll-O-Crimp Repair & Replacement Items

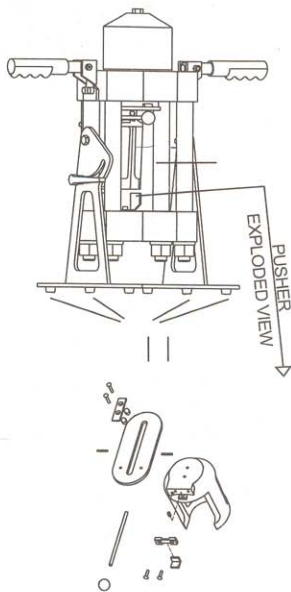

CATALOG NUMBER	DESCRIPTION
T-480-P	Pusher
T-480-PSK	Pusher Stop Repair Kit (Includes pusher clip, 2 machine screws, pusher stop & spring)
T-480-SP	Slider Plate
140-05485-01	Roll Pin
T-480-SFK	Slide Flange Kit (Includes slide flange, 2 bushings & 2 machine screws)
T-480-SPR	Slide Pull Rod
T-480-SPK	Slide Pull Knob
140-06601	Vinyl Grip
T-480-TBK	Tilt Bracket Knob
140-06894	Foot Pad
T-480-69	Tool Locator Bracket
T-480-16	10,000 PSI replacement hose assembly for 480-HP
T-480-17	10,000 PSI replacement hose assembly for T-480-TA and T-480-EP
T-480-18	10,000 PSI replacement hose assembly for 480-AH
140-06906	Hydraulic Quick Coupler used with the T-480-TA and T-480-EP System
T-480-3	Turbo Air/Hydraulic replacement pump for T-480-TA System
T-481-110	Electric replacement pump for T-480-EP System
T-480-2	Hand replacement pump for T-480-HP System
T-482-2	Air/Hydraulic replacement pump for T-480-AH System
T-480-E	Shroud Decal
T-480-M	Set-up & Operating Guide for T-480 System

Equipment

Coll-O-Crimp Pumps

T-481-110 • Electric Pump (110 volt)



For use with T-480-EP.

Pump Specifications:

Dimensions:14-14"High x
9-5/8" long x 9-5/8" wide

Weight:32 lbs.

Operation Pressure:
0-10,000 PSI

Hydraulic Oil: Use Enerpac
Oil ONLY

T-482-2 • Air/Hydraulic Pump

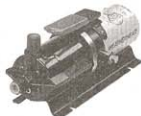

For use with T-480-AH.

Pump Specifications:

Dimensions:5"High, 14-5/8"
long, 5-5/8" wide

Weight:12 lbs.

Operation Pressure:
0-10,000 PSI

Hydraulic Oil: Use Enerpac
Oil ONLY

T-421-FP • 4 Prong Female Electrical Outlet

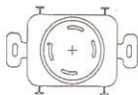

All Weatherhead 220v Coll-O-Crimp power pumps are equipped with a four prong electrical outlet as illustrated. To obtain corresponding female wall receptacle order T-421-FP. For use with T-421U, T-441 & T-433 pumps.

Repair and Replacement Items for Discontinued T-401-1 Pump

For repair and replacement items for the following pumps please contact an Enerpac Distributor at www.enerpac.com: T-402-2, T-403-2, T-480-2, T-462-2, T-480-2, T-480-3, T-481-110 & T-482-2.

CATALOG NUMBER	DESCRIPTION
T-401-1B	Replacement Gasket between motor and square reservoir
T-401-1BC	Breather Cap for Fenner-Stone pumps
T-401-1G	Relief Handle Spring (Models prior to 1982)
T-401-1S	Toggle Switch
T-401-SVF	Shuttle Valve for Fenner-Stone pump