

Equipment

Coll-O-Crimp Portable T-480



Refer to safety information regarding Coll-O-Crimp hose, hose fittings and assembly equipment compatibility on page 3.

T-480-HP • Portable Coll-O-Crimp Press & Hand Pump Package



Refer to pages 356-367 for Coll-O-Crimp tooling, tooling packages and pumps.

Refer to safety information regarding Coll-O-Crimp crimping procedures on page 338.

Make factory-type hose assemblies anywhere-anytime! Versatile and portable, this package offers the ease of use you are looking for in a Coll-O-Crimp hose assembly system. The T-480 Coll-O-Crimp Press packages are offered in four options. Listed below are press/power unit packages.

For cabinets see page 370-373 (not included).

Capacity: 3/16" I.D. 1 fiber braid through 1-1/4" I.D. 6 spiral hose

Mounting: Free Standing Base

Size: 22-1/2" high, 14" long, 10-1/2" wide

Total Weight: 112 lbs.

T-480-AH • Portable Coll-O-Crimp Press & Air/Hydraulic Pump Package



Refer to pages 356-366 for Coll-O-Crimp tooling, tooling packages and pumps.

Refer to safety information regarding Coll-O-Crimp crimping procedures on page 339.

Capacity: 3/16" I.D. 1 fiber braid through 1-1/4" I.D. 6 spiral hose

Mounting: Free Standing Base

Size: 22-1/2" high, 14" long, 10-1/2" wide

Total Weight: 124 lbs.

T-480-2 Pump Specifications:

Dimensions: 7-3/16" high, 21-1/64" long, 4-3/4" wide

Pressure: 0-10,000 psi

Outlet Port Size: 3/8" NPT

Hydraulic Oil: Enerpac

Reservoir Capacity: 55 cu. in.

Includes T-480-68 blue pusher extension ring to be used with T-480 Portable Coll-O-Crimp and the T-420 collets only.

For replacement pump see page 363-366.

T-482-2 Pump Specifications:

Dimensions: 5" high, 14-5/8" long, 5-5/8" wide

Pressure: 0-10,000 psi

Outlet Port Size: 3/8" NPT

Inlet Port: 1/4" NPT

Pump Inlet Air Pressure: 60-100 psi

Hydraulic Oil: Enerpac

Reservoir Capacity: 36 cu. in.

Includes T-480-68 blue pusher extension ring to be used with T-480 Portable Coll-O-Crimp and the T-420 collets only.

Note: It is recommended that a filter, regulator, lubricator, and air pressure gauge be installed upstream from the pump. Filter, regulator and lubricator units are not included.

For replacement pump see page 363-366.

Equipment

Coll-O-Crimp Portable T-480



Refer to safety information regarding Coll-O-Crimp hose, hose fittings and assembly equipment compatibility on page 3.

T-480-TA • Portable Coll-O-Crimp Press & Turbo Air/Hydraulic Pump Package



Reference pages 356-367 for Coll-O-Crimp tooling, tooling packages and pumps.

Refer to safety information regarding Coll-O-Crimp crimping procedures on page 340.

Capacity: 3/16" I.D. 1 fiber braid through 1-1/4" I.D. 6 spiral hose

Mounting: Free Standing Base

Size: 22-1/2" high, 14" long, 10-1/2" wide

Total Weight: 116 lbs.

T-480-3 Pump

Specifications:

Dimensions: 8-1/4" high, 12-3/8" long, 8" wide

Pressure: 0-10,000 psi

Outlet Port Size: 3/8" NPT

Inlet Port: 1/4" NPT

Pump Inlet Air Pressure: 40-150 psi

Hydraulic Oil: Enerpac

Reservoir Capacity: 150 cu. in.

Includes T-480-68 blue pusher extension ring to be used with T-480 Portable Coll-O-Crimp and the T-420 collets only.

Note: It is recommended that a filter, regulator, lubricator, and air pressure gauge be installed upstream from the pump. Filter, regulator and lubricator units are not included.

For replacement pump see page 363-366.

T-480-EP • Portable Coll-O-Crimp Press & 110v Electric Pump Package



Reference pages 356-367 for Coll-O-Crimp tooling, tooling packages and pumps.

Refer to safety information regarding Coll-O-Crimp crimping procedures on page 340.

Capacity: 3/16" I.D. 1 fiber braid through 1-1/4" I.D. 6 spiral hose

Mounting: Free Standing Base

Size: 22-1/2" high, 14" long, 10-1/2" wide

Total Weight: 134 lbs.

T-481-110 Pump

Specifications:

Electrical Power Source: 15amp, 110v grounded 1Ph 50/60HZ

Dimensions: 14-1/4" high, 9-5/8" long, 9-5/8" wide

Pressure: 0-10,000 psi

Outlet Port Size: 3/8" NPT

Hydraulic Oil: Enerpac

Reservoir Capacity: 115.5 cu. in.

Flow: .5 to 1.0 gpm

Motor Rating: 1/2 hp universal, 9 amps at 10,000 psi

Includes T-480-68 blue pusher extension ring to be used with T-480 Portable Coll-O-Crimp and the T-420 collets only.

For replacement pump see page 363-366.

Equipment

Coll-O-Crimp Portable T-480

 Refer to safety information regarding Coll-O-Crimp hose, hose fittings and assembly equipment compatibility on page 3.

T-480 • Portable Coll-O-Crimp Repair & Replacement Items

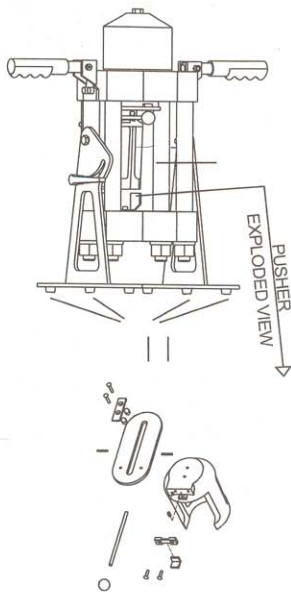

CATALOG NUMBER	DESCRIPTION
T-480-P	Pusher
T-480-PSK	Pusher Stop Repair Kit (Includes pusher clip, 2 machine screws, pusher stop & spring)
T-480-SP	Slider Plate
140-05485-01	Roll Pin
T-480-SFK	Slide Flange Kit (Includes slide flange, 2 bushings & 2 machine screws)
T-480-SPR	Slide Pull Rod
T-480-SPK	Slide Pull Knob
140-06601	Vinyl Grip
T-480-TBK	Tilt Bracket Knob
140-06894	Foot Pad
T-480-69	Tool Locator Bracket
T-480-16	10,000 PSI replacement hose assembly for 480-HP
T-480-17	10,000 PSI replacement hose assembly for T-480-TA and T-480-EP
T-480-18	10,000 PSI replacement hose assembly for 480-AH
140-06906	Hydraulic Quick Coupler used with the T-480-TA and T-480-EP System
T-480-3	Turbo Air/Hydraulic replacement pump for T-480-TA System
T-481-110	Electric replacement pump for T-480-EP System
T-480-2	Hand replacement pump for T-480-HP System
T-482-2	Air/Hydraulic replacement pump for T-480-AH System
T-480-E	Shroud Decal
T-480-M	Set-up & Operating Guide for T-480 System