



# CAPS non-threaded

## T Series Tapered Caps

Tapered Caplugs can be used as either caps or plugs. Because they are tapered in design and made from highly pliable (or flexible) polyethylene, they can not only be applied to fit snugly but are also readily removable. Especially recommended for use on MIL Std. and SAE-type tube and hydraulic fittings and for threaded external and internal NPT fittings.

Popular size Tapered Caplugs are stocked also in green FlexTemp, a flexible thermoplastic rubber for extreme temperature applications ranging from -90°F to 300°F (-68°C to 149°C).

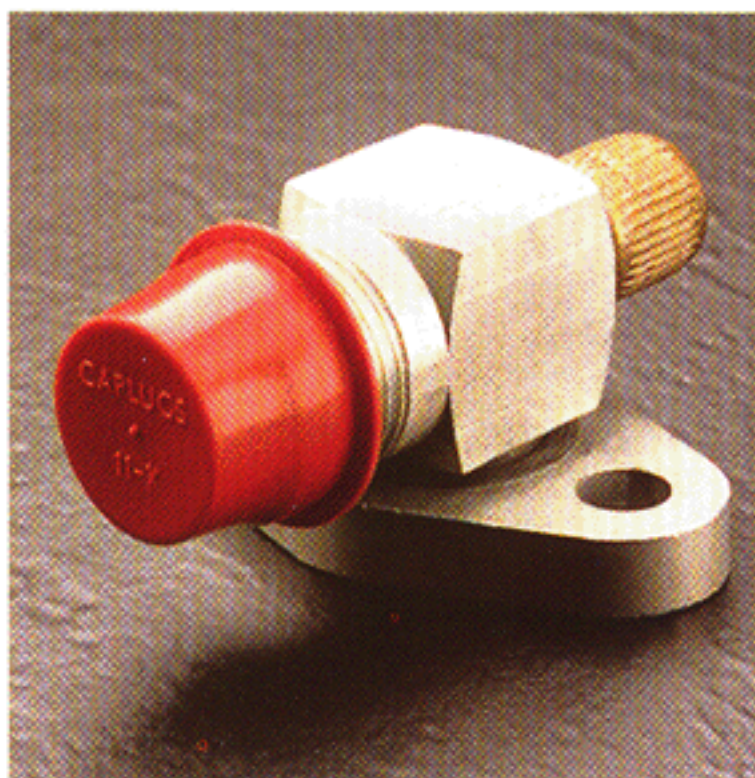
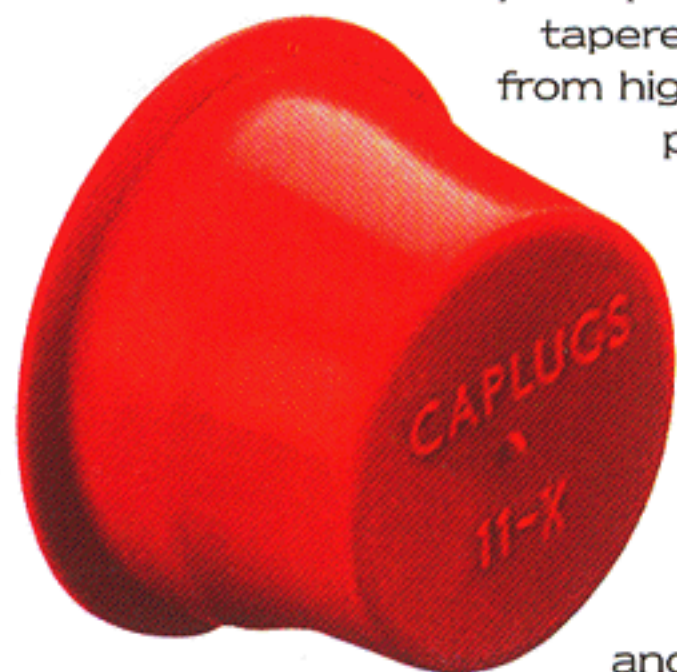

**MATERIAL:** Low Density Polyethylene  
**COLOR\*:** Red

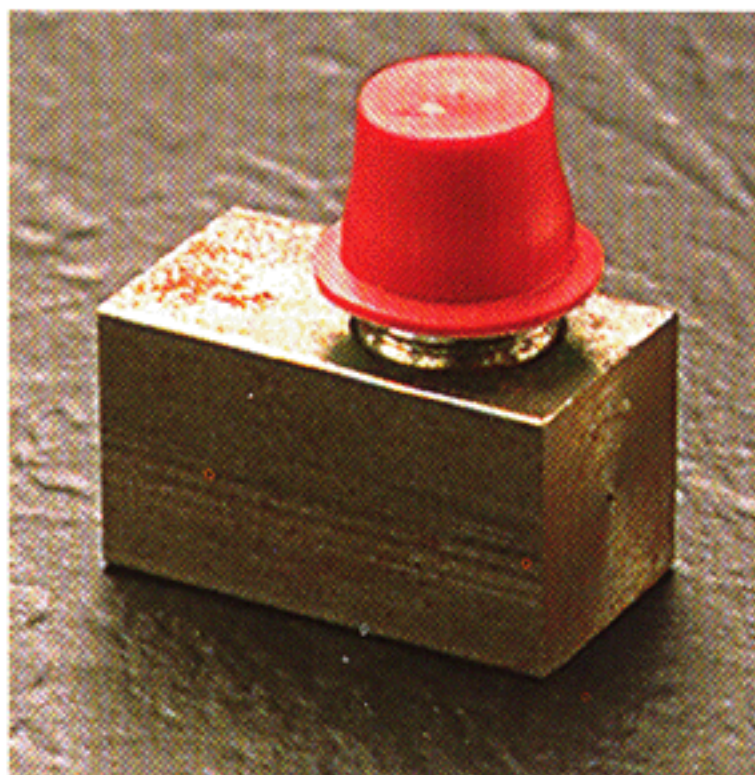
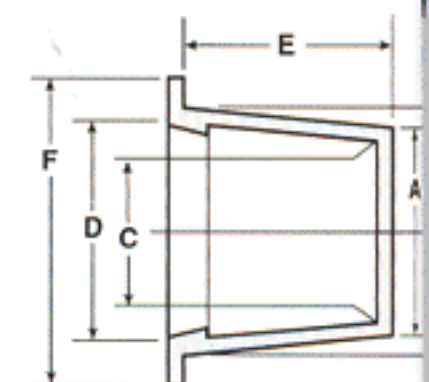
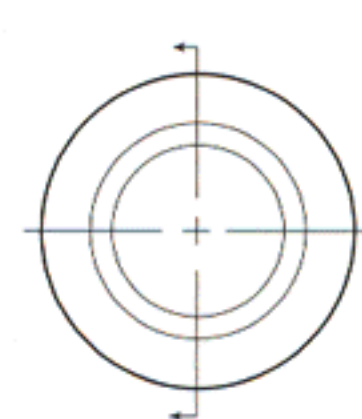





## T Series

Applicable Specs.: MIL-C-5501/7 (MIL-C-52078), NAS-834

### Selection Charts

#### Recommended closures for tube and hydraulic fittings\*\*

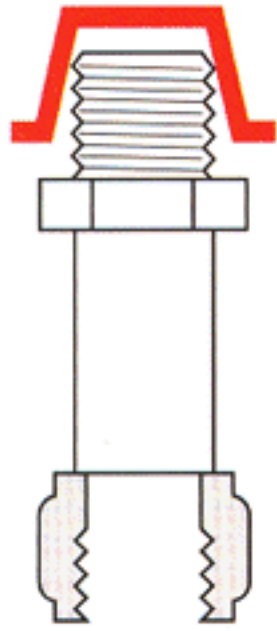

Caplug No.	Fitting Size (Dash No.)	Tubing Outside Diameter	To Fit Thread Size	Caplug No.
T-2	-2	1/8	5/16 - 24	T-2
T-3-X	-3	3/16	3/8 - 24	T-3-X
T-4-X	-4	1/4	7/16 - 20	T-4-X
T-5	-5	5/16	1/2 - 20	T-5
T-6-X	-6	3/8	9/16 - 18	T-6-X
T-7	-	3/8	5/8 - 18	T-7
T-9-X	-8	1/2	3/4 - 16	T-9-X
T-11-X	-10	5/8	7/8 - 14	T-11-X
T-13-X	-12	3/4	1 1/16 - 12	T-13-X
T-15-X	-16	1	1 5/16 - 12	T-15-X
T-18	-20	1 1/4	1 5/8 - 12	T-18
T-20	-24	1 1/2	1 7/8 - 12	T-20
T-230	-28	1 3/4	2 1/4 - 12	T-230
T-250	-32	2	2 1/2 - 12	T-250

#### Recommended closures for threaded external NPT fittings\*\*\*

Based on average tapped hole fit. It is suggested that sample Caplugs be tried for size before ordering in quantity.

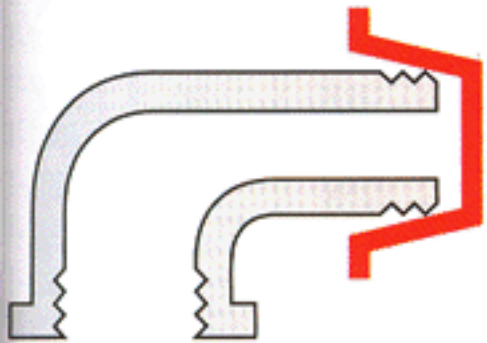

Caplug No.	NPT Size	Caplug No.
T-4	1/8	T-4
T-6	1/4	T-6
T-8-X	3/8	T-8-X
T-11	1/2	T-11
T-13-X	3/4	T-13-X
T-15-X	1	T-15-X
T-18	1 1/4	T-18
T-20	1 1/2	T-20
T-240	2	T-240
T-45-A	2 1/2	T-45-A
T-96-A	3	T-96-A
T-502	3 1/2	T-502
T-1072	4	T-1072
T-1086	5	T-1086
T-1103	6	T-1103

#### Recommended closures for unthreaded standard weight pipe\*\*\*

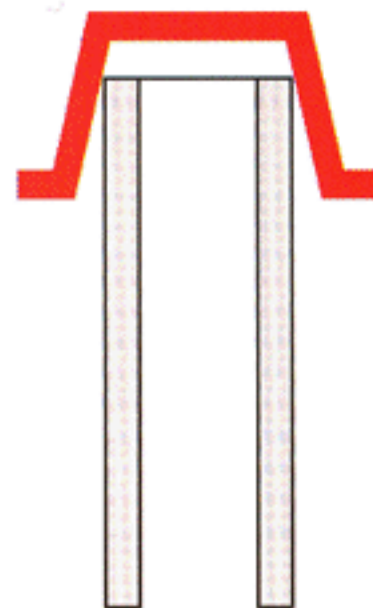

Caplug No.	Size	Caplug No.
T-4	1/8	T-4
T-6-X	1/4	T-6-X
T-8-X	3/8	T-8-X
T-11	1/2	T-11
T-13-X	3/4	T-13-X
T-16	1	T-16
T-18-X	1 1/4	T-18-X
T-210	1 1/2	T-210
T-240	2	T-240
T-45-A	2 1/2	T-45-A
T-1050	3	T-1050
T-1064	3 1/2	T-1064
T-1072	4	T-1072
T-1107	6	T-1107
T-1139	8	T-1139

\*\*For other tapered style caps see:

Series	Pages
WW	22-23
W	24-25
WWX	24-25
PTC	34-35

\*\*\*For threaded caps see:

Series	Pages
CD	76-77
ASC	76-77
PC	78-79





# CAPS non-threaded

## T Series Tapered Caplugs (cont'd)

EXPANDED

Caplug No.	Dimensions												Packaging			
	A		B		C		D		E		F		Standard Carton		Mini Pak Quantity	
	in	mm	in	mm	in	mm	in	mm	in	mm	in	mm	Shipping Wt. (Approx.) lbs	kgs		No. of Pieces
<i>T-00</i>	.116	2.95	.182	4.62	.053	1.35	.120	3.05	.38	9.65	.31	7.87	2	0.9	5000	1000
<i>T-00-S</i>	.140	3.56	.180	4.57	.088	2.24	.109	2.77	.22	5.59	.31	7.87	4	1.8	5000	1000
<i>T-00-X</i>	.145	3.68	.205	5.21	.079	2.01	.150	3.81	.38	9.65	.41	10.41	3	1.3	5000	1000
<i>T-0</i>	.173	4.39	.240	6.10	.111	2.82	.177	4.50	.38	9.65	.38	9.65	3	1.3	5000	1000
<i>T-1</i>	.236	5.99	.302	7.67	.174	4.42	.240	6.10	.38	9.65	.44	11.18	3	1.3	5000	1000
<i>T-1-X</i>	.267	6.78	.335	8.51	.205	5.21	.273	6.93	.38	9.65	.47	11.94	4	1.8	5000	1000
<i>T-2</i>	.299	7.59	.365	9.27	.235	5.97	.302	7.67	.38	9.65	.50	12.70	4	1.8	5000	1000
<i>T-2-S</i>	.325	8.26	.367	9.32	.263	6.68	.305	7.75	.19	4.83	.50	12.70	3	1.3	5000	1000
<i>T-2-X</i>	.330	8.38	.396	10.06	.267	6.78	.333	8.46	.38	9.65	.53	13.46	4	1.8	5000	1000
<i>T-3</i>	.361	9.17	.427	10.85	.298	7.57	.365	9.27	.38	9.65	.56	14.22	5	2.2	5000	1000
<i>T-3-X</i>	.390	9.91	.456	11.58	.327	8.31	.394	10.01	.38	9.65	.59	14.99	6	2.7	5000	1000
<i>T-4</i>	.419	10.64	.485	12.32	.356	9.04	.422	10.72	.38	9.65	.63	16.00	6	2.7	5000	1000
<i>T-4-X</i>	.447	11.35	.513	13.03	.385	9.78	.451	11.46	.38	9.65	.66	16.76	6	2.7	5000	1000
<i>T-5</i>	.471	11.96	.547	13.89	.409	10.39	.485	12.32	.44	11.18	.69	17.53	7	3.1	5000	1000
<i>T-5-S</i>	.533	13.54	.562	14.28	.477	12.12	.506	12.85	.22	5.59	.68	17.27	5	2.2	5000	1000
<i>T-5-X</i>	.500	12.70	.576	14.63	.440	11.18	.516	13.11	.44	11.18	.72	18.29	7	3.1	5000	1000
<i>T-6</i>	.532	13.51	.608	15.44	.468	11.89	.545	13.84	.44	11.18	.75	19.05	8	3.6	5000	1000
<i>T-6-S</i>	.554	14.07	.612	15.55	.490	12.45	.551	14.00	.31	7.87	.75	19.05	6	2.7	5000	1000
<i>T-6-X</i>	.550	13.97	.631	16.03	.487	12.37	.568	14.43	.47	11.94	.75	19.05	8	3.6	5000	1000
<i>T-7</i>	.580	14.73	.667	16.94	.518	13.16	.605	15.37	.50	12.70	.81	20.57	9	4.0	5000	1000
<i>T-7-X</i>	.610	15.49	.695	17.65	.549	13.95	.634	16.10	.50	12.70	.84	21.34	10	4.5	5000	1000
<i>T-8</i>	.640	16.26	.727	18.47	.578	14.68	.664	16.87	.50	12.70	.88	22.35	10	4.5	5000	1000
<i>T-8-S</i>	.669	16.99	.694	17.63	.613	15.57	.638	16.21	.19	4.83	.75	19.05	7	3.1	5000	1000
<i>T-8-X</i>	.675	17.15	.755	19.18	.613	15.57	.693	17.60	.50	12.70	.88	22.35	10	4.5	5000	1000
<i>T-9</i>	.690	17.53	.788	20.02	.628	15.95	.726	18.44	.56	14.22	.94	23.88	13	5.8	5000	1000
<i>T-9-S</i>	.740	18.80	.765	19.43	.678	17.22	.703	17.86	.19	4.83	.88	22.35	7	3.1	5000	1000
<i>T-9-X</i>	.725	18.42	.823	20.91	.663	16.84	.761	19.33	.56	14.22	.97	24.64	13	5.8	5000	1000
<i>T-10</i>	.750	19.05	.848	21.54	.687	17.45	.785	19.94	.56	14.22	1.00	25.40	13	5.8	5000	1000
<i>T-11</i>	.802	20.37	.911	23.14	.740	18.80	.849	21.57	.63	16.00	1.06	26.93	15	6.8	5000	1000
<i>T-11-X</i>	.815	20.70	.930	23.62	.753	19.13	.868	22.05	.63	16.00	1.09	27.69	16	7.2	5000	1000
<i>T-11-S</i>	.837	21.26	.890	22.61	.757	19.23	.810	20.57	.22	5.59	1.05	26.67	12	5.4	5000	1000
<i>T-12</i>	.866	22.00	.975	24.77	.803	20.40	.912	23.17	.63	16.00	1.13	28.70	17	7.6	5000	1000
<i>T-12-X</i>	.915	23.24	1.040	26.42	.855	21.72	.980	24.89	.69	17.53	1.16	29.47	18	8.1	5000	1000
<i>T-13-A</i>	.960	24.38	1.047	26.59	.900	22.86	.987	25.07	.50	12.70	1.19	30.23	17	7.6	5000	1000
<i>T-13</i>	.964	24.49	1.090	27.69	.901	22.89	1.027	26.09	.75	19.05	1.25	31.75	12	5.4	2500	500
<i>T-13-X</i>	.995	25.27	1.145	29.08	.933	23.70	1.083	27.51	.75	19.05	1.31	33.28	12	5.4	2500	500
<i>T-14</i>	1.094	27.79	1.215	30.86	1.031	26.19	1.152	29.26	.75	19.05	1.41	35.82	14	6.3	2500	500
<i>T-14-X</i>	1.175	29.85	1.284	32.61	1.113	28.27	1.222	31.04	.63	16.00	1.44	36.58	14	6.3	2500	500
<i>T-15-A</i>	.836	21.24	1.305	33.15	.777	19.74	1.247	31.68	1.06	26.93	1.43	36.32	15	6.8	2500	500
<i>T-15</i>	1.224	31.09	1.355	34.42	1.161	29.49	1.292	32.82	.75	19.05	1.50	38.10	15	6.8	2500	500
<i>T-15-X</i>	1.235	31.37	1.360	34.55	1.173	29.80	1.298	32.97	.81	20.57	1.50	38.10	16	7.2	2500	500
<i>T-15-S</i>	1.285	32.64	1.346	34.19	1.227	31.17	1.288	32.72	.38	9.65	1.47	37.34	19	8.6	5000	1000
<i>T-16-A</i>	1.140	28.96	1.420	36.07	1.085	27.56	1.358	34.49	.81	20.57	1.56	39.63	14	6.3	2500	500
<i>T-16</i>	1.312	33.33	1.465	37.21	1.249	31.73	1.402	35.61	.88	22.35	1.63	41.40	19	8.6	2500	500
<i>T-16-S</i>	1.395	35.43	1.465	37.21	1.345	34.16	1.405	35.69	.39	9.91	1.59	40.39	5	2.2	1000	200
<i>T-17-A</i>	1.239	31.47	1.507	38.28	1.169	29.69	1.437	36.50	.75	19.05	1.63	41.40	16	7.2	2500	500
<i>T-17</i>	1.447	36.76	1.600	40.64	1.384	35.15	1.537	39.04	.88	22.35	1.75	44.45	9	4.0	1000	200
<i>T-17-S</i>	1.513	38.43	1.600	40.64	1.451	36.86	1.537	39.04	.50	12.70	1.75	44.45	16	7.2	2500	500
<i>T-18</i>	1.560	39.63	1.682	42.72	1.498	38.05	1.620	41.15	.75	19.05	1.88	47.75	9	4.0	1000	200
<i>T-18-X</i>	1.630	41.40	1.750	44.45	1.568	39.83	1.688	42.88	.75	19.05	1.94	49.28	10	4.5	1000	200
<i>T-19</i>	1.750	44.45	1.880	47.75	1.688	42.88	1.818	46.18	.75	19.05	2.00	50.80	9	4.0	1000	200
<i>T-20-A</i>	1.440	36.58	1.895	48.13	1.378	35.00	1.833	46.56	1.28	32.51	2.06	52.33	11	4.9	1000	200
<i>T-20</i>	1.780	45.21	1.950	49.53	1.718	43.64	1.888	47.96	1.00	25.40	2.13	54.10	12	5.4	1000	200
<i>T-20-S</i>	1.781	45.24	1.805	45.85	1.722	43.74	1.746	44.35	.38	9.65	2.00	50.80	7	3.1	1000	200
<i>T-210</i>	1.844	46.84	2.000	50.80	1.781	45.24	1.938	49.23	1.00	25.40	2.13	54.10	12	5.4	1000	200

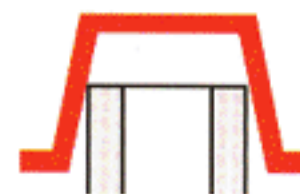
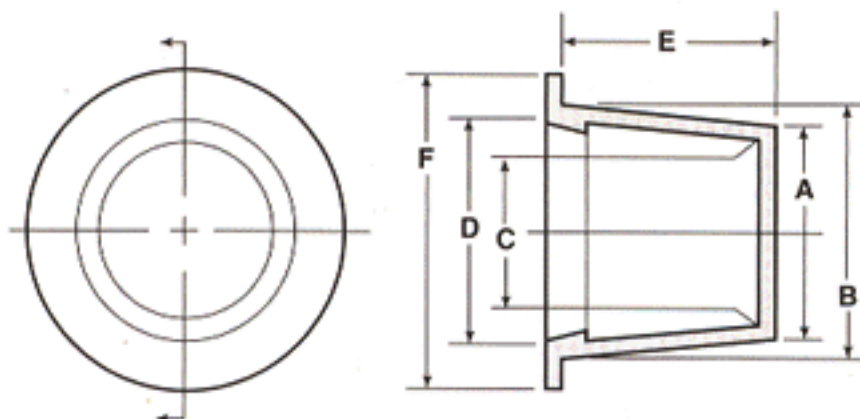

**WHEN CAPPING**  
"C" Dim. must be at least 1% smaller than diameter to be capped. Minimum .020".

Note: part number in *red italics* also available from stock in FlexTerm



# non-threaded CAPS



## T Series (cont'd)

Specs.: MIL-C-5501/7 (MIL-C-52078), NAS-834

Dimensions												Packaging			Caplug No.	
A		B		C		D		E		F		Standard Carton		Mini Pak Quantity		
in	mm	in	mm	in	mm	in	mm	in	mm	in	mm	Shipping Wt. (Approx.)				No. of Pieces
												lbs	kgs			
1.738	44.15	2.163	54.94	1.668	42.37	2.093	53.16	1.18	29.97	2.31	58.68	13	5.8	1000	200	T-21-A
1.900	48.26	2.076	52.73	1.837	46.66	2.013	51.13	1.00	25.40	2.25	57.15	14	6.3	1000	200	T-21
1.975	50.17	2.132	54.15	1.913	48.59	2.070	52.58	1.00	25.40	2.25	57.15	13	5.8	1000	200	T-220
1.935	49.15	2.310	58.68	1.875	47.63	2.255	57.28	.85	21.59	2.47	62.74	12	5.4	1000	200	T-22-A
2.015	51.18	2.147	54.54	1.953	49.61	2.085	52.96	.75	19.05	2.31	58.68	12	5.4	1000	200	T-22-S
2.067	52.50	2.243	56.97	2.005	50.93	2.181	55.40	1.00	25.40	2.44	61.98	13	5.8	1000	200	T-221
2.136	54.26	2.312	58.73	2.074	52.68	2.250	57.15	1.00	25.40	2.56	65.03	15	6.8	1000	200	T-230
2.230	56.64	2.260	57.41	2.168	55.07	2.198	55.83	.50	12.70	2.50	63.50	12	5.4	1000	200	T-24-S
2.125	53.98	2.406	61.11	2.063	52.40	2.344	59.54	1.00	25.40	2.53	64.26	14	6.3	1000	200	T-25-A
2.298	58.37	2.464	62.59	2.235	56.77	2.401	60.99	1.00	25.40	2.63	66.80	10	4.5	500	100	T-240
2.395	60.84	2.602	66.09	2.333	59.26	2.540	64.52	1.03	26.16	2.81	71.38	10	4.5	500	100	T-250
2.480	62.99	2.644	67.16	2.418	61.42	2.582	65.59	.63	16.00	2.78	70.61	14	6.3	1000	200	T-33-A1
2.307	58.60	2.650	67.31	2.245	57.03	2.588	65.74	1.25	31.75	2.78	70.61	10	4.5	500	100	T-33-A
2.457	62.41	2.750	69.85	2.395	60.84	2.688	68.28	1.00	25.40	2.88	73.15	11	4.9	500	100	T-43-A
2.555	64.90	2.690	68.33	2.493	63.32	2.628	66.75	.63	16.00	2.88	73.15	16	7.2	1000	200	T-43-X
2.641	67.08	2.790	70.87	2.579	65.51	2.728	69.29	.75	19.05	2.94	74.68	9	4.0	500	100	T-44
2.760	70.11	2.990	75.95	2.685	68.20	2.947	74.86	1.00	25.40	3.13	79.51	10	4.5	500	100	T-45-A
2.849	72.37	2.980	75.69	2.787	70.79	2.918	74.12	.75	19.05	3.25	82.55	10	4.5	500	100	T-500
2.975	75.57	3.103	78.82	2.915	74.04	3.041	77.24	.75	19.05	3.34	84.84	11	4.9	500	100	T-53
2.982	75.75	3.245	82.43	2.912	73.97	3.175	80.65	1.00	25.40	3.38	85.86	12	5.4	500	100	T-55-A
3.090	78.49	3.370	85.60	3.020	76.71	3.300	83.82	1.00	25.40	3.50	88.90	15	6.8	500	100	T-57-A
3.325	84.46	3.457	87.81	3.245	82.43	3.377	85.78	.75	19.05	3.63	92.21	9	4.0	250	50	T-501
3.270	83.06	3.562	90.48	3.200	81.28	3.492	88.70	1.13	28.70	3.69	93.73	9	4.0	250	50	T-96-A
3.47	88.14	3.60	91.44	3.41	86.62	3.54	89.92	.75	19.05	3.88	98.56	16	7.2	500	100	T-1050
3.55	90.17	3.73	94.75	3.48	88.40	3.66	92.97	1.00	25.40	4.00	101.60	10	4.5	250	50	T-1051
3.68	93.48	3.80	96.52	3.61	91.70	3.73	94.75	.75	19.05	4.00	101.60	9	4.0	250	50	T-1052
3.79	96.27	3.92	99.57	3.71	94.24	3.84	97.54	.75	19.05	4.12	104.65	9	4.0	250	50	T-502
3.93	99.83	4.07	103.38	3.86	98.05	4.00	101.60	.75	19.05	4.38	111.26	10	4.5	250	50	T-1063
4.02	102.11	4.14	105.16	3.94	100.08	4.07	103.38	.75	19.05	4.53	115.07	11	4.9	250	50	T-1064
4.09	103.89	4.32	109.73	4.01	101.86	4.24	107.70	1.25	31.75	4.62	117.35	14	6.3	250	50	T-1067
4.27	108.46	4.43	112.53	4.18	106.18	4.34	110.24	.88	22.35	4.88	123.96	15	6.8	250	50	T-1070
4.37	111.00	4.62	117.35	4.29	108.97	4.54	115.32	1.00	25.40	5.00	127.01	14	6.3	250	50	T-1072
4.64	117.86	4.85	123.19	4.57	116.08	4.78	121.42	.88	22.35	5.25	133.36	14	6.3	250	50	T-1076
4.79	121.67	4.97	126.24	4.71	119.64	4.89	124.21	1.00	25.40	5.38	136.66	16	7.2	250	50	T-1078
4.91	124.72	5.09	129.29	4.83	122.69	5.01	127.26	1.00	25.40	5.50	139.71	15	6.8	250	50	T-1079
4.99	126.75	5.20	132.09	4.92	124.97	5.10	129.55	1.00	25.40	5.63	143.01	16	7.2	250	50	T-1080
5.18	131.58	5.36	136.15	5.11	129.80	5.29	134.37	1.00	25.40	5.88	149.36	19	8.6	250	50	T-1084
5.33	135.39	5.49	139.45	5.21	132.34	5.37	136.40	.88	22.35	5.88	149.36	19	8.6	250	50	T-1086
5.47	138.94	5.62	142.75	5.39	136.91	5.54	140.72	1.00	25.40	6.13	155.71	18	8.1	250	50	T-1088
5.57	141.48	5.75	146.06	5.49	139.45	5.67	144.02	1.00	25.40	6.19	157.23	19	8.6	250	50	T-1090
5.70	144.79	5.87	149.10	5.61	142.50	5.79	147.07	.98	24.89	6.25	158.76	19	8.6	250	50	T-1092
6.01	152.66	6.18	156.98	5.92	150.37	6.10	154.95	1.00	25.40	6.62	168.15	19	8.6	250	50	T-1097
6.18	156.98	6.35	161.30	6.09	154.69	6.26	159.01	1.00	25.40	6.75	171.46	10	4.5	100	20	T-1100
6.40	162.57	6.56	166.63	6.33	160.79	6.49	164.85	.87	22.10	6.94	176.28	10	4.5	100	20	T-1103
6.61	167.90	6.71	170.44	6.53	165.87	6.63	168.41	1.50	38.10	7.19	182.63	13	5.8	100	20	T-1107
6.88	174.75	7.03	178.56	6.80	172.72	6.95	176.53	.50	12.70	7.67	194.82	12	5.4	100	20	T-1108-S
7.05	179.08	7.12	180.86	6.97	177.04	7.06	179.33	1.00	25.40	7.63	193.81	14	6.3	100	20	T-1109
7.34	186.44	7.65	194.32	7.26	184.41	7.56	192.03	1.00	25.40	7.94	201.68	13	5.8	100	20	T-1110
7.66	194.57	7.84	199.14	7.58	192.54	7.76	197.11	1.00	25.40	8.12	206.26	12	5.4	100	20	T-1120
7.97	202.45	8.14	206.76	7.88	200.16	8.05	204.48	1.00	25.40	8.38	212.86	13	5.8	100	20	T-1128
8.15	207.02	8.35	212.10	8.05	204.48	8.25	209.56	1.38	35.05	8.75	222.26	10	4.5	50	10	T-1133
8.40	213.37	8.60	218.45	8.30	210.83	8.50	215.91	1.38	35.05	9.00	228.61	10	4.5	50	10	T-1137
8.67	220.23	8.73	221.75	8.55	217.18	8.60	218.45	1.50	38.10	9.13	231.91	11	4.9	50	10	T-1139

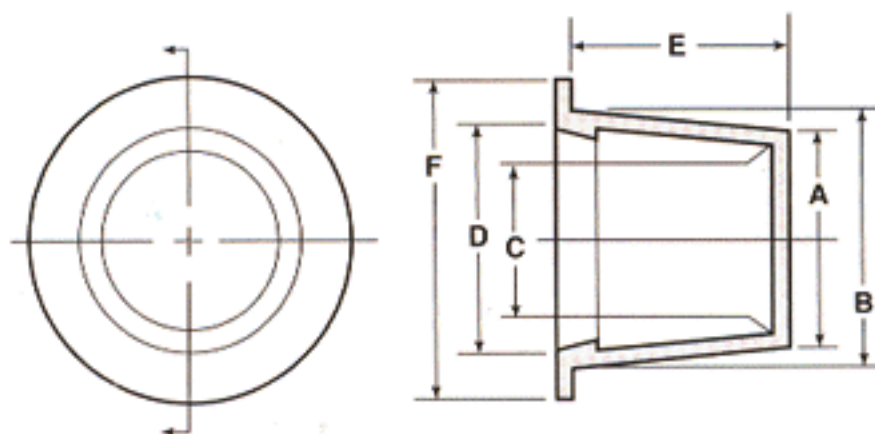

**WHEN CAPPING**  
"C" Dim. must be at least 1% smaller than diameter to be capped. Minimum .020".